

# REX<sup>®</sup>

## Y-Pattern Strainer Cast Steel A216 WCB Class 300

Body and Cover Cast Steel A216 WCB  
Class 300

Norm Steel Valves: ANSI/ASME B16.34  
Flange dimensions: ANSI/ASME B16.5 RF  
Face to Face dimensions: ANSI/ASME B16.10

Screen Stainless Steel 316 o 304  
Mesh 40

Hydrostatic Testing API 598  
Diameters: 2" to 12"

### PRESSURE TEMPERATURE RATINGS

Temperature °F/°C	Pressure worked lbs/inch <sup>2</sup> (PSI)
	Class 300
(-) 20 °F / (-) 29 °C to (+) 100 °F / (+) 38 °C	740
200 °F / 93 °C	675
300 °F / 149 °C	655
400 °F / 204 °C	635
500 °F / 260 °C	600
600 °F / 316 °C	550
650 °F / 343 °C	535
700 °F / 371 °C	535
750 °F / 399 °C	505
800 °F / 427 °C	410
850 °F / 454 °C	270
900 °F / 482 °C	170
950 °F / 510 °C	105
1000 °F / 538 °C	50



\* Reference photo

\* Note : Dimensions, design and materials are subject to change without notice.



# Y-Pattern Strainer Cast Steel A216 WCB Class 300

## MATERIALS

	PART NAME	MATERIAL
1	BODY	CARBON STEEL A216 Gr. WCB
2	COVER	CARBON STEEL A216 Gr. WCB
3	SCREEN	STAINLESS STEEL 316 or 304
4	GASKET	STAINLESS STEEL SPIRAL WOUND
5	STUDS	ALLOY STEEL
6	NUTS	CARBON STEEL
7	BLOW-OFF PLUG NPT	CARBON STEEL

TEST API 598

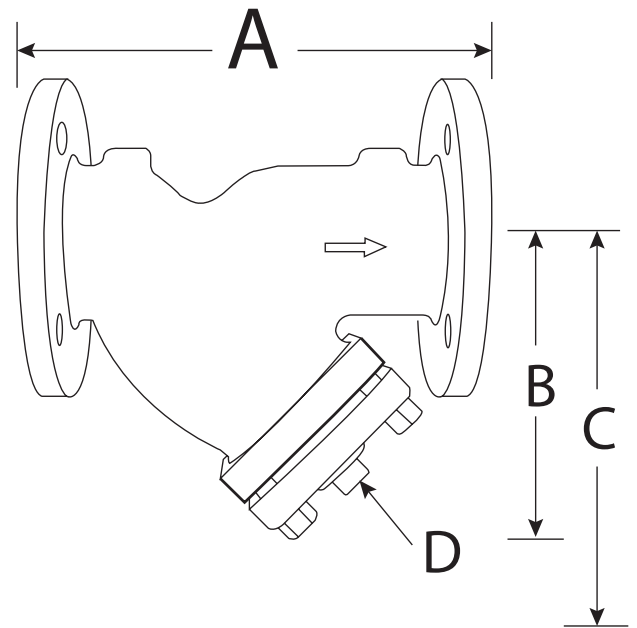

\* The screen is stainless steel screen of 40mesh/in.

## DIMENSIONS (mm)

SIZE	A	B	C	D	FACTOR CV	WEIGHT (KG)
2"	245	134	178	15	70	11.79
2 1/2"	270	166	248	25	110	18.10
3"	305	178	254	25	160	23.81
4"	369	210	305	4	260	42.64
5"	491	286	432	50	400	73.20
6"	491	343	508	50	570	84.41
8"	594	394	578	50	950	117.93
10"	696	470	712	50	1600	185.07
12"	813	553	762	50	2200	286.67

\* Note : Dimensions, design and materials are subject to change without notice.